

## 15 Gallon Rolling Oil Drain Pan

# Installation and Operation Manual

Manual P/N 5900378 — Manual Revision A3— December 2024

Models:

- DP-30



**Designed and engineered by BendPak Inc. in Southern California, USA. Made in China.**

 **DANGER**

Read the entire contents of this manual before using this product. Failure to follow the instructions and safety precautions in this manual can result in serious injury or death. Make sure all other operators also read this manual. Keep the manual near the product for future reference. By proceeding with setup and operation, you agree that you fully understand the contents of this manual.

---

**Manual.** DP-30 Rolling Oil Drain Pan, *Installation and Operation Manual*, Manual P/N 5900378, revision A3, released December 2024.

**Copyright.** Copyright © 2024 by BendPak Inc. All rights reserved. You may make copies of this document if you agree that: you will give full attribution to BendPak Inc., you will not make changes to the content, you do not gain any rights to this content, and you will not use the copies for commercial purposes.

**Trademarks.** BendPak, and the BendPak logo are registered trademarks of BendPak Inc. All other company, product, and service names are used for identification only. All trademarks and registered trademarks mentioned in this manual are the property of their respective owners.

**Limitations.** Every effort has been made to have complete and accurate instructions in this manual. However, product updates, revisions, and/or changes may have occurred since this manual was published. BendPak reserves the right to change any information in this manual without incurring any obligation for equipment previously or subsequently sold. BendPak is not responsible for typographical errors in this manual. Feel free to contact us at any time to get the latest information about any product: [bendpak.com](https://bendpak.com).

**Warranty.** The BendPak warranty is more than a commitment to you: it is also a commitment to the value of your new product. For full warranty details, contact your nearest BendPak dealer or visit [bendpak.com/support/warranty](https://bendpak.com/support/warranty).

**Safety.** Your new product was designed and manufactured with safety in mind. Your safety also depends on proper training and thoughtful operation. Do not set up, operate, maintain, or repair the unit without reading and understanding this manual and the labels on it; **do not use this product unless you can do so safely!**

**Owner Responsibility.** In order to maintain your product properly and to ensure operator safety, it is the responsibility of the product owner **to read and follow these instructions:**

- Follow all setup, operation, and maintenance instructions.
- Make sure product setup conforms to all applicable local, state, and federal codes, rules, and regulations, such as state and federal OSHA regulations.
- Read and follow all safety instructions. Keep them readily available for operators.
- Make sure all operators are properly trained, know how to safely operate the unit, and are properly supervised.
- Do not operate the product until you are certain that all parts are in place and operating correctly.
- Carefully inspect the product on a regular basis and perform all maintenance as required.
- Service and maintain the unit only with approved replacement parts.
- Keep the manual with the product and make sure all labels are clean and visible.

**Only use this product if it can be used safely!**

**Unit Information.** Record the Model Number, and the Date of Purchase below. This information is required for part or warranty issues.

Model: \_\_\_\_\_

Date of Purchase: \_\_\_\_\_

---

# Table of Contents

<b>Introduction</b> .....	<b>3</b>	<b>Assembly</b> .....	<b>7</b>
<b>Shipping Information</b> .....	<b>3</b>	<b>Operation</b> .....	<b>8</b>
<b>Safety Considerations</b> .....	<b>4</b>	<b>Labels</b> .....	<b>10</b>
<b>Specifications</b> .....	<b>6</b>	<b>Parts List</b> .....	<b>11</b>
<b>Features</b> .....	<b>7</b>	<b>Maintenance</b> .....	<b>11</b>

## Introduction

This manual describes the DP-30 Rolling Oil Drain Pan with dual height slider tubes. More information about the full line of BendPak Products is available at [bendpak.com](http://bendpak.com). ***This manual is mandatory reading for all users of the DP-30***, including anyone who assembles, operates, maintains, or repairs it.

 **DANGER**

Be very careful when setting up, operating, maintaining, or repairing this equipment; failure to do so could result in property damage, product damage, injury, or in very rare cases death. Make sure only authorized personnel operate this equipment. All repairs must be performed by an authorized technician. Do not make modifications to the unit; this voids the warranty and increases the chances of injury or property damage. Make sure to read and follow the instructions in the manual and on the labels applied to the unit.

Keep this manual on or near the equipment so that anyone who uses or services it can read it. Technical support for your Oil Drain is available from your distributor or directly from BendPak visit the [BendPak Support website](#).

## Shipping Information

Your equipment was carefully checked before shipping. Nevertheless, you should thoroughly inspect the shipment **before** you sign to acknowledge that you received it.

When you sign the bill of lading, it tells the carrier that the items on the invoice were received in good condition. ***Do not sign the bill of lading until after you have inspected the shipment.*** If any of the items listed on the bill of lading are missing or damaged do not accept the shipment until the carrier makes a notation on the bill of lading that lists the missing or damaged goods.

If you discover missing or damaged goods **after** you receive the shipment and have signed the bill of lading, notify the carrier at once and request the carrier to make an inspection. If the carrier will not make an inspection, prepare a signed statement to the effect that you have notified the carrier (on a specific date) and that the carrier has failed to comply with your request.

It is difficult to collect for loss or damage after you have given the carrier a signed bill of lading. If this happens to you, file a claim with the carrier promptly. Support your claim with copies of the bill of lading, freight bill, invoice, and photographs, if available. Our willingness to assist in helping you process your claim does not make us responsible for collection of claims or replacement of lost or damaged materials.

---

# Safety Considerations

**Read this entire manual carefully before using your new product.** Do not install or operate the product until you are familiar with all operating instructions and warnings. Do not allow anyone else to operate the product until they are familiar with all operating instructions and warnings.

**⚠ WARNING California Proposition 65.** This product can expose you to chemicals including styrene and vinyl chloride which are on the list of over 900 chemicals identified by the State of California to cause cancer, birth defects or reproductive harm. Always use this product in accordance with BendPak's instructions. For more information, visit [www.p65warnings.ca.gov](http://www.p65warnings.ca.gov).

**⚠ WARNING Always** refer to the Material Safety Data Sheet (MSDS) for safe handling and disposal information on the substances you intend to place in the DP-30. MSDS are available from the substance's supplier or manufacturer.

## Important Safety Information

When using this equipment, basic safety precautions should always be followed, including:

- The product is a Rolling Oil Pan. **Use it only for its intended purpose.**
- This safety information and the warnings throughout this manual cannot cover all possible conditions and situations. Common sense and caution are required at all times when using this equipment.
- **Do not drain caustic or volatile fluids or fuels into the DP-30.** These Fluids could cause damage to the equipment and personal injury.
- The product should only be operated by trained and authorized personnel. Keep children and untrained personnel away from the product.
- When using the product, wear appropriate personal safety equipment, work clothes and ANSI-approved safety goggles. Do not wear loose clothing or jewelry. Keep hair and clothing away from moving parts. Always comply with the personal protective equipment required.
- Automotive Fluids may be hot and cause severe burns or injury to skin and eyes! Temperatures can exceed 220° F (104° C). Use Caution. Allow the engine oil to cool prior to draining into the Pan.
- Some oil systems may be under pressure; opening these systems while hot can cause oil to be sprayed forcefully and injury may result.
- Used oils are flammable, keep away from open flames or other ignition sources.
- Always comply with local, state, and national regulations for the disposal of Waste Fluids.
- Repair leaks and clean fluid spills immediately.
- Do not use the product while tired or under the influence of drugs, alcohol, or medication.
- **Never** alter or make any modifications to the product.
- **Never** use the DP-30 as a stool or step.
- Verify the unit is firmly resting on the Lift's Rolling Bridge Beam and the beam is clean with no obstructions that would interfere with the unit's travel.
- Make a visual inspection of the product before using it. Do not use the product if you find any missing or damaged parts. Instead, take the unit out of service, then contact an authorized repair facility, your distributor, or BendPak at **(805) 933-9970**. Follow the prompts to reach sales or service.
- BendPak recommends making a **thorough** inspection of the product at least once a year. Replace any damaged, cracked or severely worn parts, decals, or warning labels.
- Contact BendPak for parts replacement information (please have the model and serial number of your unit available) at **(805) 933-9970**. Follow the prompts to reach sales or service.
- Read all instructions. Use only as described in this manual.
- Make sure all operators read and understand this *Installation and Operation Manual*. **Always Keep the manual near the Oil Drain.** The Oil Drain should only be operated by authorized personnel. Keep children and untrained personnel away.

---

## Symbols

Following are the symbols used in this manual:



**DANGER**

Calls attention to a hazard that **will** result in death or injury.



**WARNING**

Calls attention to a hazard or unsafe practice that **could** result in death or injury.



**CAUTION**

Calls attention to a hazard or unsafe practice that could result in personal injury, product damage, or property damage.

**NOTICE**

Calls attention to information that can help you use your equipment better.

## Liability Information

BendPak assumes **no** liability for damages resulting from:

- Use of the product for purposes other than those described in this manual.
- Modifications to the equipment without prior, written permission from BendPak Inc.
- Injury or death caused by modifying, disabling, overriding, or removing safety features.
- Damage to the equipment from external influences.
- Incorrect operation of the equipment.

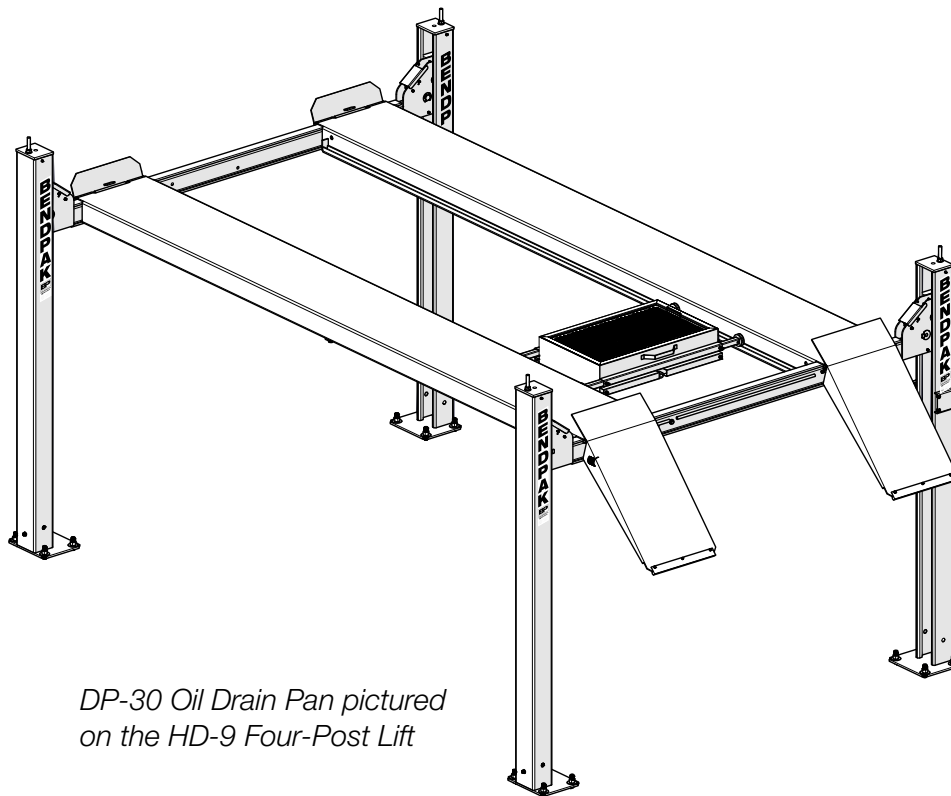

*DP-30 Oil Drain Pan pictured  
on the HD-9 Four-Post Lift*

# Specifications

<b>Dimensions, Overall L x W x H</b>	36.5 x 23.75 x 8 in. (925 x 603 x 202 mm)
<b>Drain Screen Dimensions L x W</b>	28.25 x 16.5 in. (715 x 420 mm)
<b>Fluid Capacity</b>	15 Gallons (56.75 Liters)
<b>Drain Port Thread</b>	ZG1/2" Standard British Pipe Thread

Unless otherwise noted, dimensions rounded to the nearest 1/4 in.

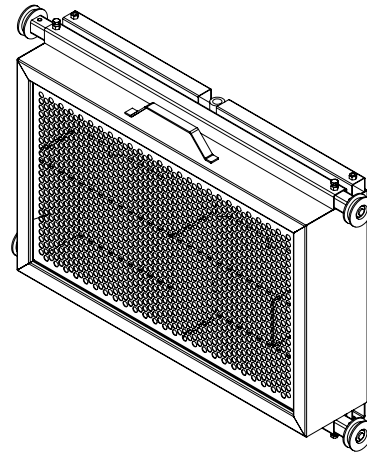

**Top View**

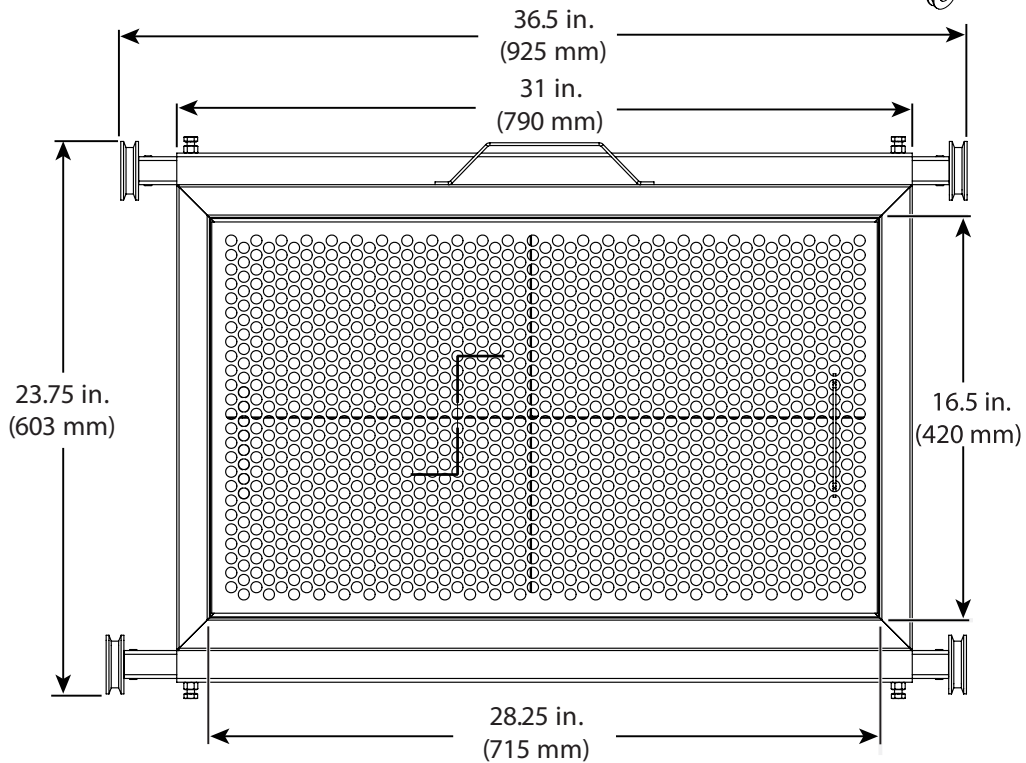

**Side View**

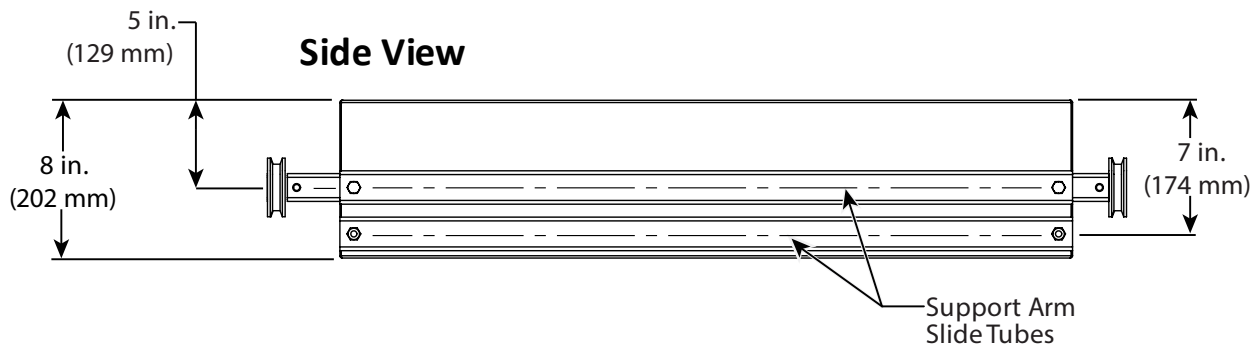

---

# Features

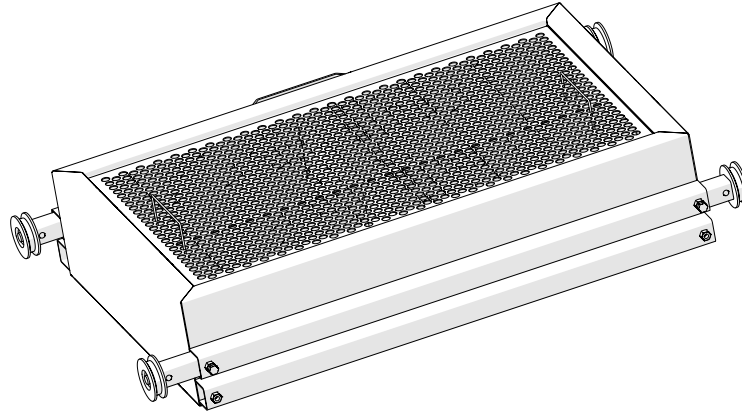

- 15-gallon capacity
- Baffles to reduce fore to aft splashing
- Dual slider tubes, high/low roller positions
- Handle for easy positioning
- Removable steel screen keeps debris out of the reservoir
- For use with many 4-Post Lifts
- Telescoping rollers
- Powder coat finish
- Removable steel screen keeps debris out
- Easy-to-use ball valve and drain hose

# Assembly

## Assemble the DP-30 Rolling Oil Drain:

1. Remove from packaging and verify all parts are present.
2. Install the ball valve into the existing threaded fitting located in the lower center section of the tank. Use a wrench to tighten securely.
3. Place the receiver screen into the recessed area on the top of the pan.

If you require further assistance, please contact BendPak for information (please have the model and serial number of your unit available) at **(805) 933-9970**. Follow the prompts to reach Customer Service.

# Operation

## Positioning the DP-30 on the Lift:

1. **The DP-30's dual support arm slide tubes** allow a choice of **two height positions** adapting to a variety of 4 Post Lifts. Simply loosen the jamb bolts and slide out the 4 support arms with rollers and insert them into the tubes to reach the optimal height for the Lift and vehicle.

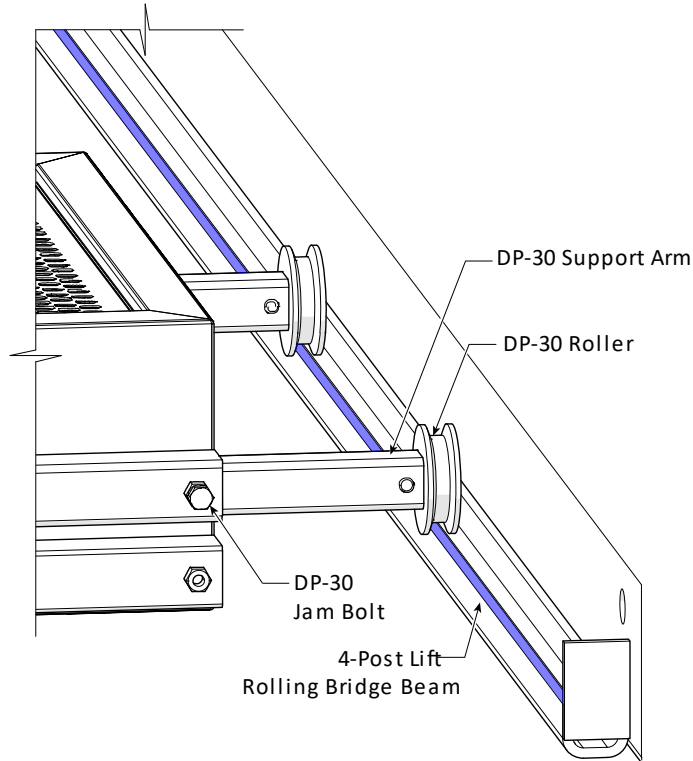

2. With the help of an assistant, place the DP-30 open side up and positioned so that all four support arms and rollers are spread to engage on both inner edges on the 4 Post Lift's bridge beam.
3. Tighten all four jamb bolts to secure the rollers on the Lift's rolling bridge beam.
4. With the DP-30 engaged properly on both beams and free to roll fore and aft, verify that the screen is in place on top of the DP-30. The screen will prevent drain plugs, tools, or other components from dropping into the waste oil reservoir.
5. Loosen the jamb bolts to position the DP-30 side-to-side then tighten the bolts to lock the DP-30 in position to catch the engine oil. The DP-30 may still be moved fore-and-aft on the Lift.

**⚠ WARNING** Automotive Fluids may be hot and cause severe burns or injury to skin and eyes! The direction of oil flowing from a particular engine is not always straight down, but often begins at a strong angle horizontally.

**⚠ WARNING** Always wear appropriate personal protective equipment. Provide fresh air ventilation to avoid the accumulation of flammable fumes. Extinguish all open flames, do not smoke in the area of draining oil.

6. Remove the vehicle's oil pan drain plug and allow the oil to drain. When appropriate, remove the oil filter and allow the oil to drain from that area as well.



- 
7. Replace the vehicle's oil drain plug and oil filter after the oil has completely drained from the vehicle. Refill the engine to specification.

**To Empty the DP-30:**

 **WARNING:** A DP-30 fully loaded with oil can weigh up to 250 lbs. (115 kg). Handle with care and use assistance when moving. Empty the Rolling Oil Drain Pan often.

 **WARNING:** Always wear appropriate personal protective gear, gloves, and eye protection, when handling waste oil.

1. Attach the supplied drain hose to the ball valve's output.
2. Move the DP-30 above the Waste Oil Container and route the drain hose to the waste container.
3. Open the ball valve to drain the DP-30.
4. When the DP-30 is empty, close the ball valve.
5. Clean any spilled oil immediately and dispose of oily rags or oil absorbent material in accordance with all national, state, and local regulations.

# Labels

**A**

BendPak®

**Rolling Oil Drain Pan**  
**DP-30**

**⚠ WARNING**

**FAILURE TO OBSERVE THESE WARNINGS MAY RESULT IN PERSONAL INJURY OR PROPERTY DAMAGE. READ OPERATING INSTRUCTIONS PRIOR TO USE. DO NOT REMOVE THIS LABEL.**

1. Hot oil can cause severe burns. Allow the engine oil to completely cool before draining the oil into the drain pan.
2. An incorrectly-supported vehicle can tilt or fall and cause injury or death. Never work under a vehicle without proper support devices.
3. Fire Hazard: Flame or heat sources may ignite the oil, resulting in fire, injury or death. Never use or store the drain pan near open flames or heat sources.
4. Engine exhaust contains Carbon Monoxide, an odorless, invisible gas that can cause injury or death. Do not use the drain pan with the vehicle engine running.
5. Always wear ANSI approved safety goggles and heat-resistant rubber gloves when using this product.
6. Read and adhere to all warnings and safety precautions in the owner's manual for this product before use.
7. Make sure the drain pan is used on a dry, clean, level surface capable of supporting the weight of the vehicle being lifted and any additional tools and equipment.
8. Remove the drain pan before lowering the vehicle.
9. Used engine oil is toxic and should be properly disposed of or recycled.

15

GAL  
CAPACITY

- ✓ Removable steel mesh
- ✓ Built-in baffles / splash-guards
- ✓ Grooved telescoping rollers
- ✓ Built-in drain nozzle

30440 Agoura Road • Agoura Hills, CA 91301 • TEL: 805-933-9970 • [www.bendpak.com](http://www.bendpak.com)

Engineered by BendPak USA • Made in China  
PN 590320

PN 5905320

**B**

**CALIFORNIA PROPOSITION 65**

**⚠ WARNING ⚠**

**WARNING!** This product can expose you to chemicals including styrene and vinyl chloride which are on the list of over 900 chemicals identified by the State of California to cause cancer, birth defects or reproductive harm. ALWAYS use this product in accordance with the manufacturer's instructions. For more information, go to [www.p65warnings.ca.gov](http://www.p65warnings.ca.gov).

PN 5905775

PN 5905775



# Parts List

Item	Description	Part Number	Qty.	Item	Description	Part Number	Qty.
1	Handle	—	1	6	Ball Valve	5210097	1
2	Screen	5210099	1	7	Hose Barb	—	1
3	Jamb Bolt M6-1.0 x 10	5402396	4	8	Drain Hose	—	1
4	Support Arm and Roller	5210076	4	9	Clamp	—	1
5	Reservoir	—	1	10	2.5" Roller Only	5210093	4

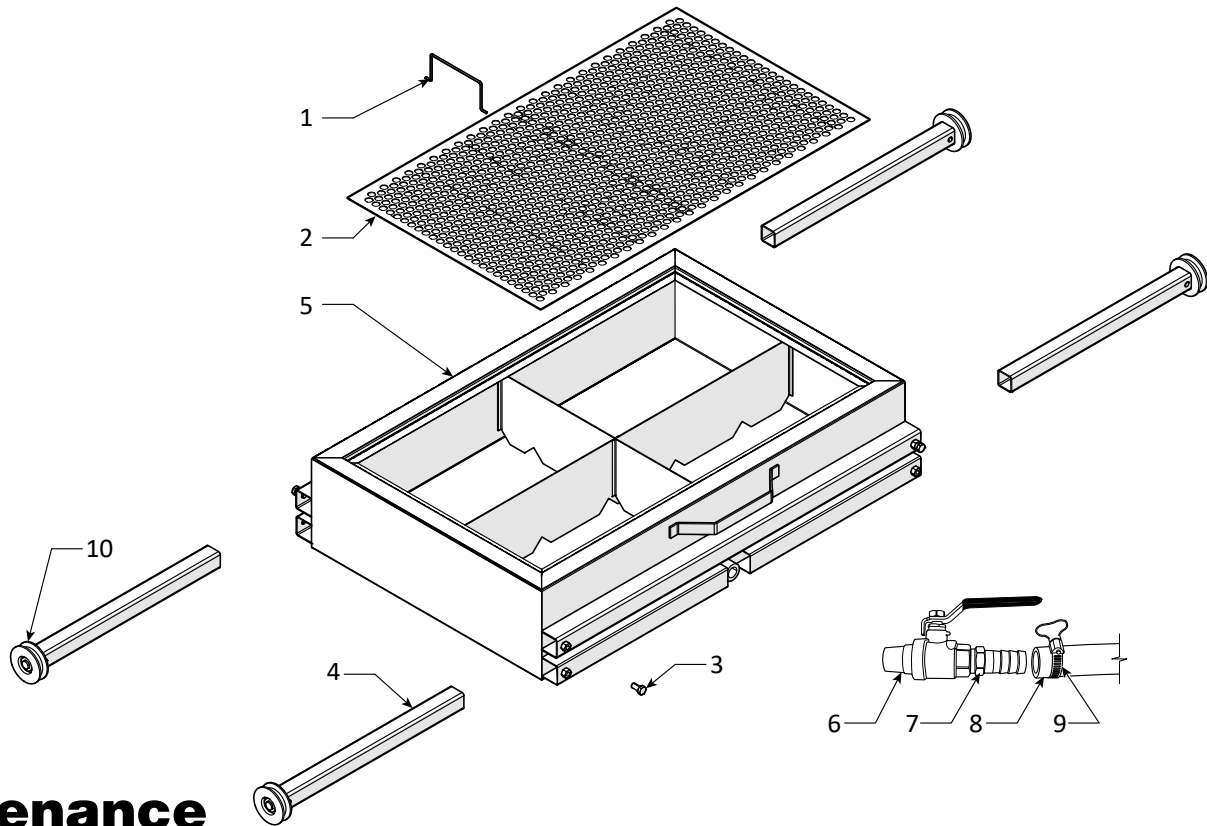

## Maintenance

**⚠ WARNING:** Always wear appropriate personal protective equipment **while performing any maintenance!**

### To maintain your Rolling Oil Drain:

- Keep the Rolling Oil Drain clean and free of debris and dirt.
- All exposed surfaces of the Oil Drain may be brushed clean and wiped with a weak solution of soap and water to remove grease and oil.
- Inspect for leaks and dispose of waste oil in accordance with all local, state, and federal regulations.
- Check Rollers and Brackets for damage and wear. Replace as required.

**⚠ WARNING** Do not operate your DP-30 if you find worn or broken components; instead, take the unit out of service, then contact your dealer, visit [bendpak.com/support/](https://www.bendpak.com/support/), or call **(805) 933-9970**. Follow the prompts to reach the Service Department.

---

**BendPak**<sup>®</sup>

30440 Agoura Rd.  
Agoura Hills, CA, 91301 USA  
[bendpak.com](https://www.bendpak.com)

---

© 2024 BendPak Inc. All rights reserved.